

Bearings

Body Diameter = 1.275 in.

Description:

- Flanged type non-precision bearing
- 47 lb. per bearing load rating
- Eleven 5/32 in. dia. hardened steel balls
- Pressed steel outer shell

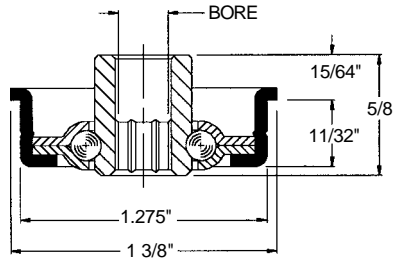

Bearing Number	Bore Size
102178	1/4" Hex
102044	5/16" Hex

(5721, 6721)

Body Diameter = 1.281 in.

Description:

- Flanged type semi-precision bearing
- 191 lb. per bearing load rating
- Seven 7/32 in. dia. hardened steel balls
- Ball retainers
- Front and back mylar seals
- Front and back shield
- Available in stainless steel

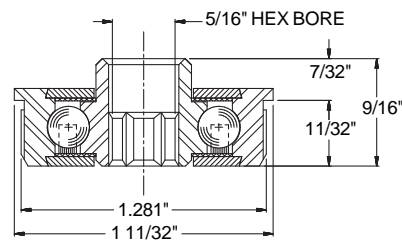

Bearing No. 102274

(SDHS-1821-RF)

Body Diameter = 1.284 in.

Description:

- Flanged type non-precision bearing
- 60 lb. per bearing load rating
- Eleven 5/32 in. dia. hardened steel balls
- Pressed steel outer shell

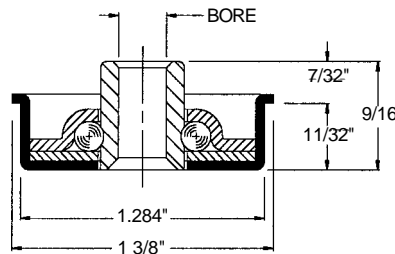

Bearing Number	Bore Size
111856	1/4" Round
102228	5/16" Hex
102241	5/16" Round

(713-3821CFB, H713-3821CFB, 252-3821CFB)

Body Diameter = 1.407 in.

Description:

- Flanged type non-precision bearing
- 75 lb. per bearing load rating
- Thirteen 3/16 in. dia. hardened steel balls
- Pressed steel outer shell
- Front teflon seal and front shield

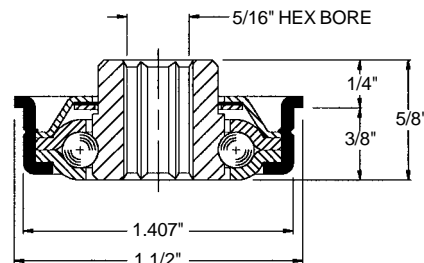

Bearing No. 102175

(0141)