

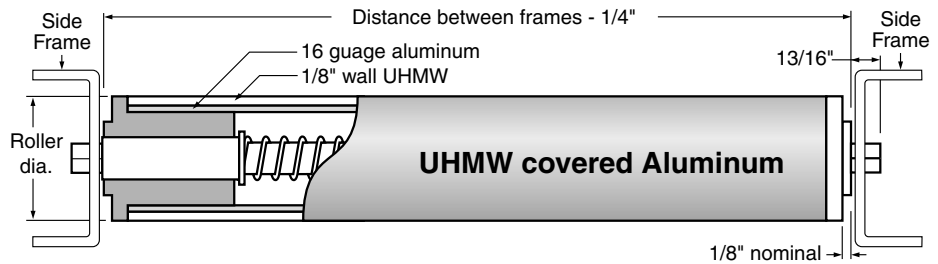

## Type C

### UHMW Roller with High Performance Sleeve Bearing

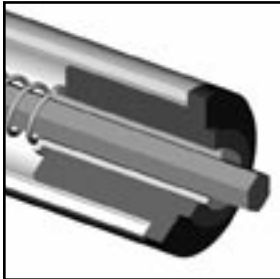

Our UHMW roller, reinforced with an aluminum tube, offers maximum abrasion resistance. Designed primarily for belt driven conveyors, the plastic sleeve bearings is an excellent choice for applications exposed to abrasive or corrosive products, candy production or printing where a non-stick surface is required. Standard shafts extend 13/16" at each end of a roller. Custom extended shaft lengths are available.

Roller material: aluminum, UHMW.

Bearing Type:	Sleeve
Bore Type:	Through
Roller Material:	UHMW covered aluminum

Shaft Diameter	Shaft Material	Hex Adapter Material	Roller Diameter	Bearing Material	Distance Between Frames
Part No. Description	Part No. Description	Part No. Description	Part No. Description	Part No. Description	
<b>7/16 hex</b> 7/16" hex	<b>CS</b> Carbon steel	<b>C</b> Carbon steel	<b>R220</b> 1.90"	<b>S</b> Nolu-S	
<b>5/16 hex</b> 5/16" hex	<b>304SS</b> 304 stainless	<b>316SS</b> 316 stainless	<b>R270</b> 2.38"		
<b>1/2</b> 1/2" round	<b>316SS</b> 316 stainless				

*Use with hex shaft.*

**C-** [ ] [ ] [ ] [ ] [ ] [ ]

w/ round shaft → **C-** [ ] [ ] [ ] [ ] [ ] [ ]

## Type D

### PVC Roller with Nolu Plastic Ball Bearing

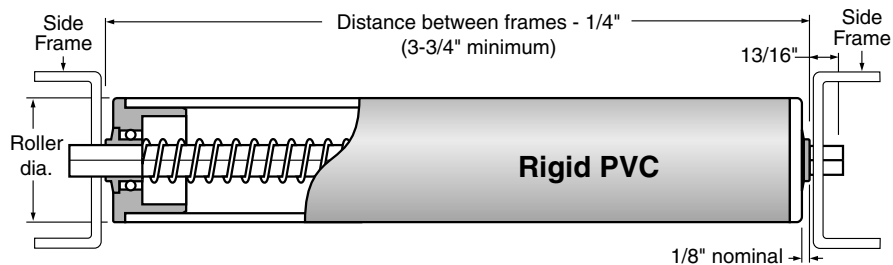

A cost effective lighter duty roller designed primarily for gravity conveyor applications. Standard shafts extend 13/16" at each end of a roller. Custom extended shaft lengths are available.

Roller material: beige, rigid PVC.

**See page 325 for Type D Roller standard part numbers.**

Bearing Type:	Ball
Bore Type:	Through
Roller Material:	PVC

Shaft Material	Roller Diameter, Shaft Diameter and Bearing Material	Distance Between Frames
Part No. Description	Part No. Roller Dia. Shaft Dia. Bearing Material	
<b>CS</b> Carbon steel	<b>NBB110</b> .81" 1/4" round Acetal w/ 420 stainless balls	
<b>304SS</b> 304 stainless	<b>NBB130</b> 1.06" 5/16" hex Acetal w/ 420 stainless balls	
<b>316SS</b> 316 stainless	<b>NBB145</b> 1.19" 5/16" round Acetal w/ 420 stainless balls	
	<b>NBB150</b> 1.31" 5/16" hex Acetal w/ 420 stainless balls	
	<b>NBB220</b> 1.90" 7/16" hex Acetal w/ 420 stainless balls	
	<b>SPB220</b> 1.90" 7/16" hex Polypropylene w/ 316 stainless balls	

**D-** [ ] [ ] [ ] [ ] [ ] [ ]