

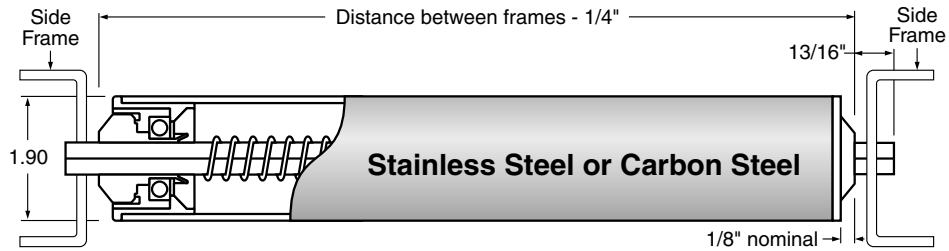

Rollers

Type I

Steel Roller with Plastic Ball Bearing

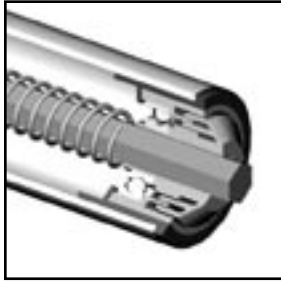

Designed primarily for belt driven conveyors and inclined gravity systems where a heavy duty roller is required. Standard shafts are 7/16" hex and extend 13/16" at each end of a roller. Custom extended shaft lengths are available.

Roller material: stainless or carbon steel.

See page 325 for Type I Roller standard part numbers.

Bearing Type:	Ball
Bore Type:	Through
Roller Material:	Steel

Shaft Material Part No.	Description	Bearing Part No.	Description	Shaft Diameter Description	Tubing Material Part No.	Description	Distance Between Frames
CS	Carbon steel	222LSB-224-01	Plastic housing with carbon steel caged bearing insert	7/16	2	Carbon steel	↓
304SS	304 stainless	222LSB-224-02	Plastic housing with carbon steel double shielded bearing insert		3	304 stainless	
316SS	316 stainless	222LSB-224-03	Plastic housing with carbon steel double rubber sealed bearing insert				



Type J

Steel / Aluminum Roller with Non-Metallic Sleeve Bearings

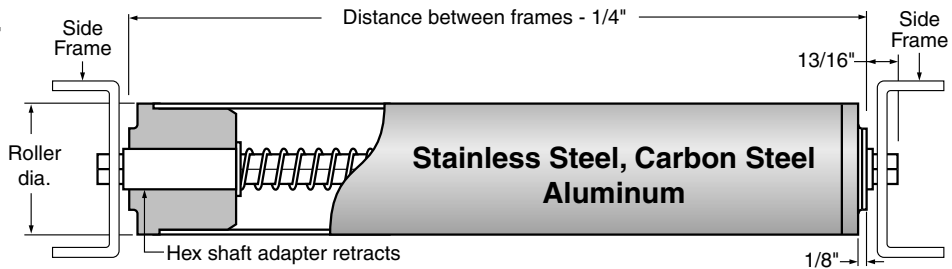
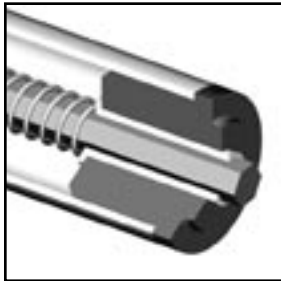

Roller can be produced from most standard tube sizes and using a conveyor roll end bearing from the table on page 339. Designed primarily for belt driven conveyors and inclined gravity systems. It provides the same rigidity as other metal tube rollers and yet eliminates all the problems associated with the use of ball bearings. Standard shafts extend 13/16" at each end of a roller. Custom extended shaft lengths are available. This roller can be purchased without a shaft if you prefer (leave shaft information out of part number).

Roller material: stock steels or aluminum.

Bearing Type:	Sleeve
Bore Type:	Through
Roller Material:	Steel

Shaft Material Part No.	Description	Hex Adapter Material Part No.	Description	Roller Dia., Gage, Bearing Material & Bore size (see pg.339) (e.g. HR-234J)	Tubing Material Part No.	Description	Distance Between Frames
CS	Carbon steel	C	Carbon steel	↓	2	Carbon steel	↓
304SS	304 stainless	316SS	316 stainless		3	304 stainless	
316SS	316 stainless				5	Aluminum	

Use with hex shaft.

