



686A-1.25



SpeedRail™

Economical bead guide used for carry surfaces or side rails. Use Valu Guide Rail Bender to form inner and outer curves. Can be cut to any length between beads. Easy fastening frame slot for horizontal and vertical applications. Operating temperature range: -10°F to +180°F.

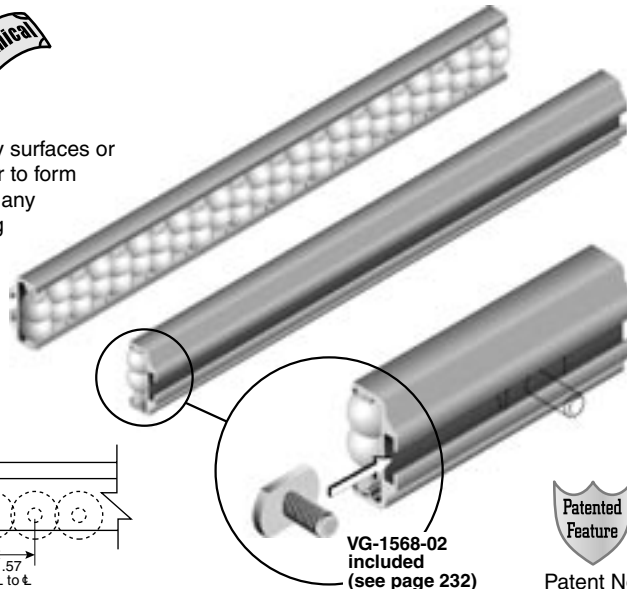
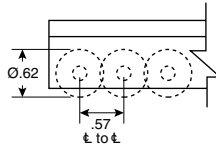
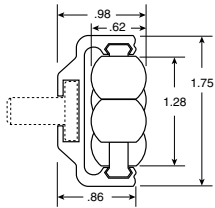

VG-1568-02 included (see page 232)



Patent No. 6,516,933

Material: Aluminum channel, FDA accepted engineered polymer pins, gray acetal beads.

Part Number	No. of Bolts Included*	Length (ft.)
VG-686A-1.25-02	3	2
VG-686A-1.25-03	3	3
VG-686A-1.25-04	3	4
VG-686A-1.25-05	4	5
VG-686A-1.25-06	4	6
VG-686A-1.25-07	5	7
VG-686A-1.25-08	5	8
VG-686A-1.25-09	6	9
VG-686A-1.25-10	6	10

*Bolts included are VG-1568-02



12" min. bending radius in either direction. Field bendable with Valu Guide rail bender on pg. 198 or custom bend request form on pg. 234.

686SP-1.25

Side Plow for SpeedRail™

Material: Nolu-S with stainless steel fastener.

Part Number
VG-686SP-1.25

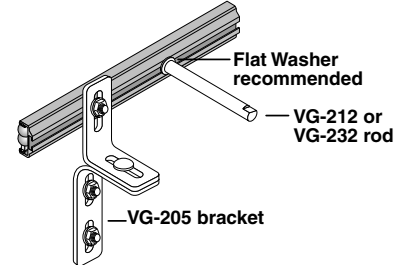
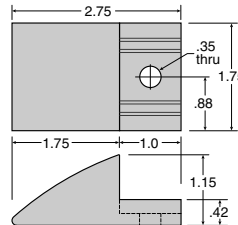
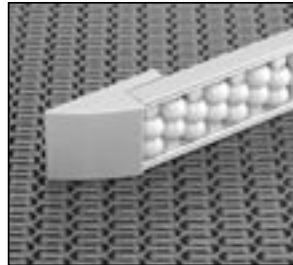

686A-3.0



2-Strand SpeedRail™

A wider bead guide used for carry surfaces or side rails. Can be cut to any length between beads. Custom bends can be ordered from the factory. Easy fastening frame slot for horizontal and vertical applications. Operating temperature range: -10°F to +180°F.

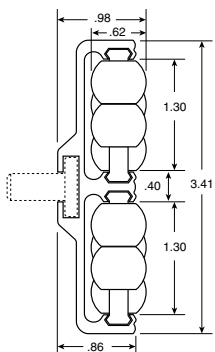

Patent No. 6,516,933

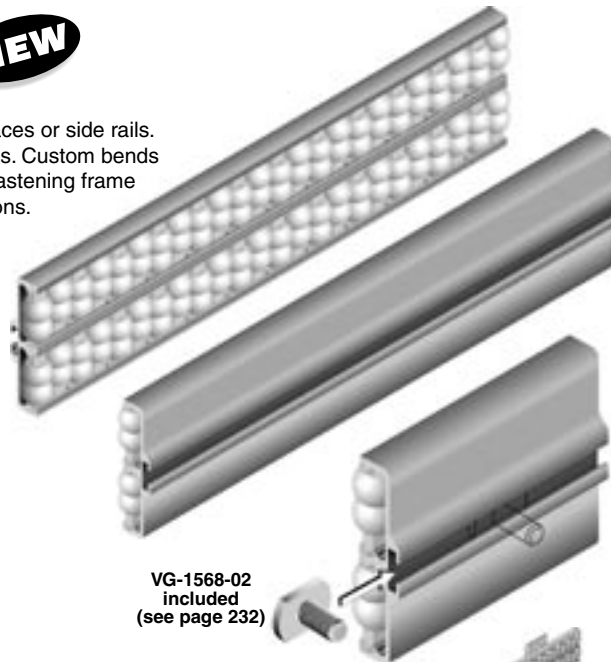

VG-1568-02 included (see page 232)

Material: Aluminum channel, FDA accepted engineered polymer pins, gray acetal beads.

Part Number	No. of Bolts Included*	Length (ft.)
VG-686A-3.0-02	3	2
VG-686A-3.0-03	3	3
VG-686A-3.0-04	3	4
VG-686A-3.0-05	4	5
VG-686A-3.0-06	4	6
VG-686A-3.0-07	5	7
VG-686A-3.0-08	5	8
VG-686A-3.0-09	6	9
VG-686A-3.0-10	6	10

*Bolts included are VG-1568-02



20" min. bending radius in either direction. See pg. 234 for custom bend request form.

686SP-3.0

Side Plow for 2-Strand SpeedRail™

Material: Nolu-S with stainless steel fastener.

Part Number
VG-686SP-3.0

