

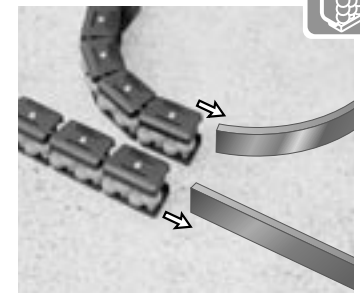

## 16500 series

### Heavy Duty, Single, Flexible Roller Module

These low noise, long life, bead guides offer quick installation and smooth operation. They are designed for rugged boxes and containers. Excellent for accumulation areas.



Modules slide onto 40mm x 8 mm flat bars or the "M" profile below. Minimum radius for a curved section is 10 in. (beads outside) and 12 in. (beads inside).

Combine these single modules together to fit custom lengths!

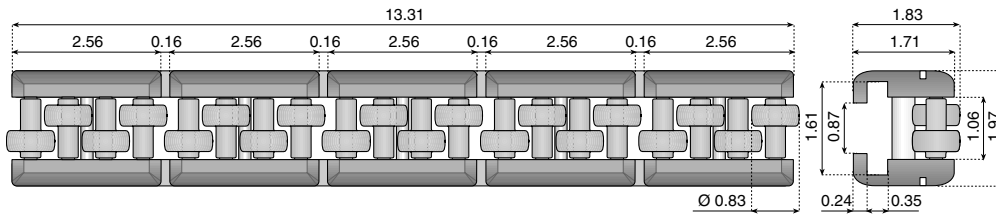

**Material:** Polyamide straps, acetal rollers and pins, nickel plated brass spacers, stainless steel screws.

Part Number	Length (inches)
16500	13.31

### Heavy Duty, Flexible Roller Assembly with Stainless Steel Support

These low noise, long life, bead guides offer quick installation and smooth operation. They are designed for rugged boxes and containers. Excellent for accumulation areas. Can be cut to length.

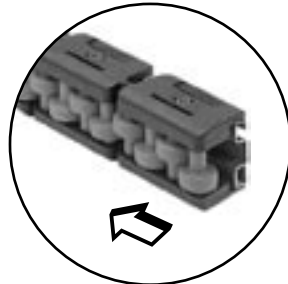

3 meter assembled section!

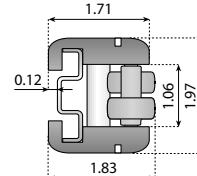

Minimum radius for a curved section is **10 in.** (beads outside) and **12 in.** (beads inside).

**Material:** Stainless steel channel. Polyamide straps, acetal rollers and pins, nickel plated brass spacers, stainless steel screws.

Part Number	Length (feet)
16550	3M (~10 ft.)

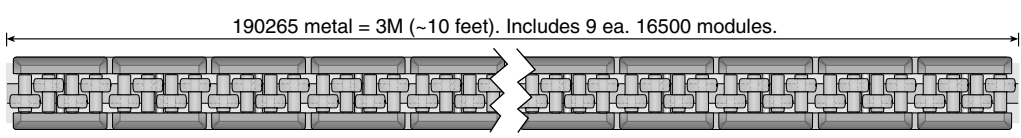

## 190265

### M-Profile

Stainless steel support for roller modules. See page 201 for compatible bender rollers.

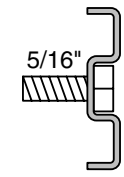
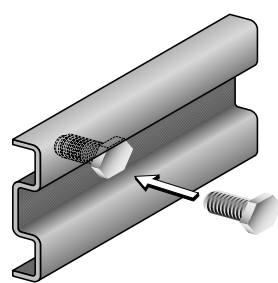
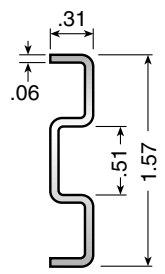

**Material:** 304 stainless steel.

Part Number	Length
190265	3M (~10 ft.)

Can be mounted by drilling a hole through the steel support. Use a 5/16" hex head to fasten.

Bead and Roller Guides