

125 Series Heavy Duty Drives

Side Drive

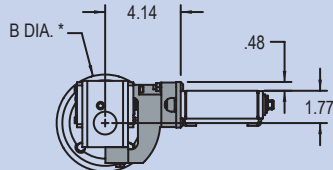

Front View

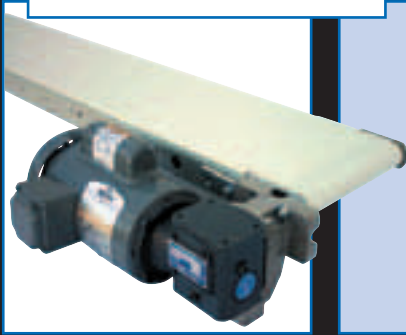
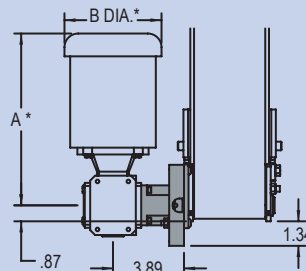

Top View

*For "A" and "B" dimensions, see table at bottom of page

Note:

This arrangement allows for the drive to be mounted on either side of the conveyor with the motor perpendicular to the drive pulley. Reference the drawings to the left for dimensional information. Reference

the tables to the right for mounting package and gearmotor ordering information. The box immediately left shows the possible drive positions.

Drive Location

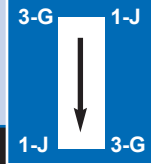

Remote Drive

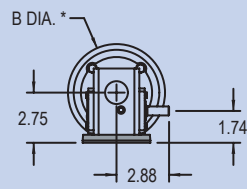

Front View

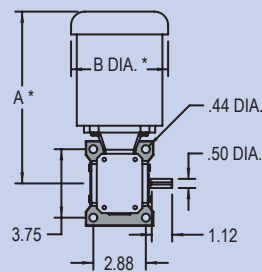

Top View

*For "A" and "B" dimensions, see table at bottom of page

Note:

This arrangement allows for the drive to be mounted away from the conveyor and on either side of the conveyor, with the motor perpendicular to the drive pulley. Reference the drawings to the left for dimensional information. Reference

the tables to the right for mounting package and gearmotor ordering information. The box immediately left shows the possible drive positions.

Drive Location

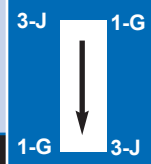

Note: 56 frame gear motors extend below gear box mounting plate and may require shimming

Top Drive

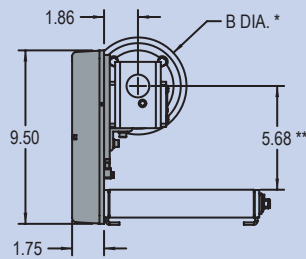

Front View

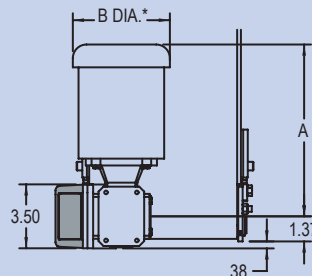

Top View

*For "A" and "B" dimensions, see table at bottom of page

**Dimension reflects use of MAA belt. See pages 20-21.

Note:

This arrangement allows for the drive to be mounted above the conveyor belt, on either side of the conveyor, and with the motor perpendicular to the drive pulley. Reference the drawings to the left for dimensional information. Reference

the tables to the right for mounting package and gearmotor ordering information. The box immediately left shows the possible drive positions.

Drive Location

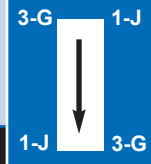

Bottom Drive

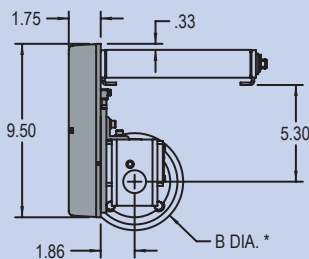
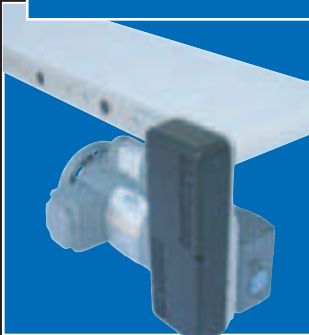

Front View

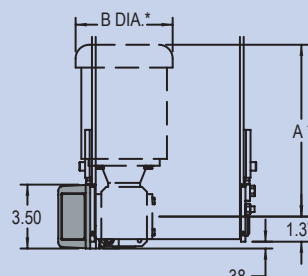

Top View

*For "A" and "B" dimensions, see table at bottom of page

Note:

This arrangement allows for the drive to be mounted below the conveyor belt, on either side of the conveyor, and with the motor perpendicular to the drive pulley. Reference the drawings to the left for dimensional information. Reference

the tables to the right for mounting package and gearmotor ordering information. The box immediately left shows the possible drive positions.

Drive Location

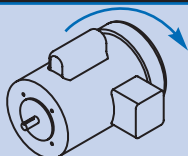
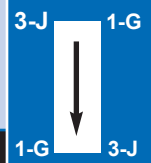

The motor can be rotated in 90° increments when attaching it to the gearbox. This allows the user flexibility when deciding where the motor capacitor and work box will be located.

Motor Dimension Chart

	161	163	16V	251	253	25V	331	333	33V	501	503	50V	503 (ID)
A	11.39	11.26	8.22	9.22	9.25	9.15	9.01	9.24	10.11	13.85	13.22	15.84	14.08
B	5.20	4.69	4.98	5.19	5.20	4.99	6.20	5.20	5.01	6.15	6.19	4.98	7.23